

**REGO+PLUS**  
dual contact toolholders



Swiss  
Precision  
Tools

**REGO-FIX®**



## powRgrip® REGO PLUS Toolholders

### CAT | PG

Type	Standard Part No.	D [mm]	L [inch]	Balancing Rings
CAT+ 40 / PG 10 x 3.5" H	4340.71006	16	3.5	FWR 285
CAT+ 40 / PG 10 x 6" H	4340.71076	16	6	FWR 285
CAT+ 40 / PG 15 x 3.15" H	4340.71546	24	3	FWR 285
CAT+ 40 / PG 15 x 6" H	4340.71576	24	6	FWR 325/285
CAT+ 40 / PG 25 x 3.15" H	4340.72546	40	3	FWR 405
CAT+ 40 / PG 25 x 6" H	4340.72576	40	6	FWR 405/405
CAT+ 40 / PG 32 x 4.3" H	4340.73256	50	4.3	FWR 505

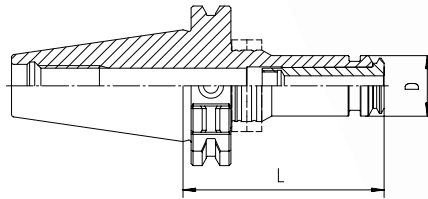

### BT | PG

Type	Standard Part No.	D [mm]	L [mm]	Balancing Rings
BT+ 40 / PG 10 x 080 H	4140.71046	16	80	FWR 285
BT+ 40 / PG 10 x 120 H	4140.71066	16	120	FWR 325
BT+ 40 / PG 15 x 080 H	4140.71546	24	80	FWR 285
BT+ 40 / PG 15 x 120 H	4140.71566	24	120	FWR 325
BT+ 40 / PG 25 x 080 H	4140.72546	40	80	FWR 405
BT+ 40 / PG 25 x 120 H	4140.72566	40	120	FWR 405
BT+ 40 / PG 25 x 160 H	4140.72586	40	160	FWR 405/405

As a Licensed BIG Plus manufacturer, REGO-FIX uses new state of the art measuring and grinding systems to create the most accurate dual contact holders that can be produced.

REGO PLUS toolholders are balanced by design to G2.5 @ 22,000 rpm and are designed for coolant through the flange (form B) and coolant through the taper (form AD) as a standard to meet your machining requirements.

Dual Contact



REGO-FIX.COM

Please call for new holders and availability of other taper types.

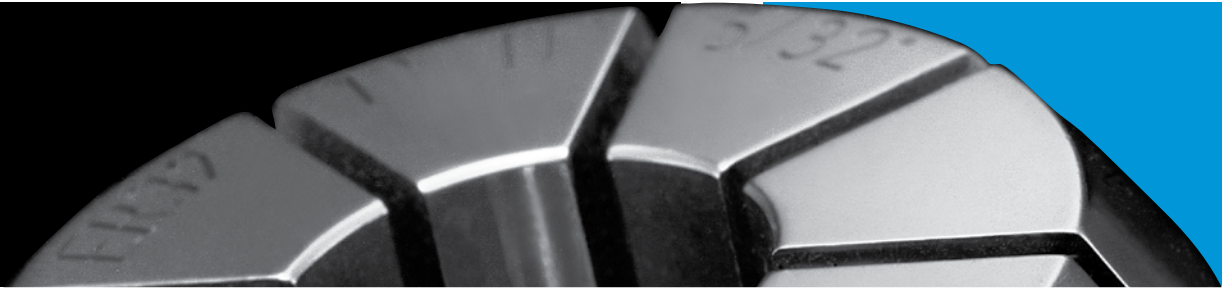

## ER REGO PLUS Toolholders

### CAT | ER

Type	Standard Part No.	D [mm]	L [inch]	Balancing Rings	Wrench
CAT+ 40 / ER 11 x 3" H	4340.11136	19	3	FWR 325	7112.11010
CAT+ 40 / ER 16 x 3" H	4340.11636	28	3	FWR 325	7112.16010
CAT+ 40 / ER 16 x 6" H	4340.11676	28	6	FWR 325/225	7112.16010
CAT+ 40 / ER 20 x 3" H	4340.12036	34	3	FWR 285	7112.20010
CAT+ 40 / ER 25 x 4" H	4340.12556	42	4	FWR 325	7111.25000
CAT+ 40 / ER 32 x 3" H	4340.13236	50	3	FWR 405	7111.32000
CAT+ 40 / ER 32 x 6" H	4340.13276	50	6	FWR 405/405	7111.32000

Coolant supply through the taper (form AD)

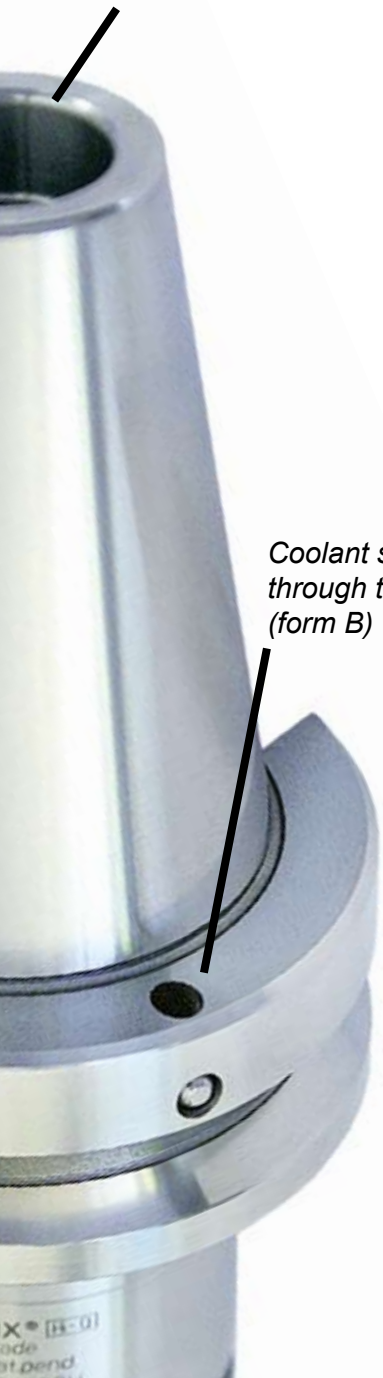

Coolant supply through the flange (form B)

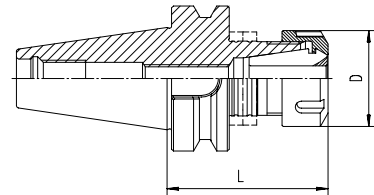

### BT | ER

Type	Standard Part No.	D [mm]	L [mm]	Balancing Rings	Wrench
BT+ 40 / ER 16 x 070 H	4140.11636	28	70	FWR 285	7112.16010
BT+ 40 / ER 16 x 100 H	4140.11656	28	100	FWR 285	7112.16010
BT+ 40 / ER 20 x 070 H	4140.12036	34	70	FWR 285	7112.2010
BT+ 40 / ER 25 x 070 H	4140.12536	42	70	FWR 405	7111.25000
BT+ 40 / ER 32 x 070 H	4140.13236	50	70	FWR 405	7111.32000
BT+ 40 / ER 32 x 100 H	4140.13256	50	100	FWR 405	7111.32000
BT+ 40 / ER 32 x 160 H	4140.13286	50	160	FWR 405/325	7111.32000

Please call for new holders and availability of other taper types.



Swiss Precision Tools

1-800-999-7346

# REGO+PLUS

dual contact toolholders

Made in  
Switzerland



## Swiss Quality

Made in Switzerland to ISO 9001/ISO 14001.

## Marking

Type and part number.

## Traceability

Lot numbers are marked on all products for traceability throughout the entire manufacturing process.

## REGO-FIX® / BIG

Licensed by BIG Daishowa for BIG Plus Spindles.

## Coolant Through

All holders are form AD for coolant through the taper and form B for coolant through the flange as a standard.

## Q+® Balancing

100% balanced to 22,000 rpm.

## Matched Tooling System for Best Fit

For highest precision and best results the whole system counts. For that reason REGO-FIX® components are carefully matched for optimum fit and accuracy. This guarantees the best run-out and balance.

## TIR of the System

REGO PLUS ER run-out of 0.0002" or better with a REGO-FIX UP Collet

REGO PLUS PG run-out of 0.0001" or better when using the REGO-FIX powRgrip® System. (See [www.rego-fix.com/pg](http://www.rego-fix.com/pg) for more details on the powRgrip system)

## REGO-FIX TOOL CORPORATION

7752 Moller Road  
Indianapolis, IN 46268 USA

Toll Free: 800.999.7346

Phone: 317.870.5959

Fax: 317.870.5955

Email: [info@rego-fix.com](mailto:info@rego-fix.com)

[www.rego-fix.com](http://www.rego-fix.com)

COL 1097.0